

Thank you for purchasing the **awave** brand series, which is a Atmos sound speaker specially designed for the non-destructive modification. They have all passed comprehensive tests to ensure its consistency and reliability.

- Before installing the mounting hole, please confirm that the installation space is appropriate.
- To prevent noise interference, make sure that the wiring is away from the engine, high voltage conductors and other potential sources of noise.
- To prevent short circuits, make sure that the wiring avoids moving parts and sharp edges.
- Before installing this product, please make sure that you have read this installation guide carefully.

ATM 2 TECHNICAL PARAMETERS:

MODEL	ATM 2
Maximum Power	25W
Speaker	1*1.8" 4 ohm
Frequency Range	165Hz~15K Hz
Sensitivity@ 1W/1M	83 dB
Box	Aluminum
Dimension (LxWxH)	Ø70 mm

Installation 1:

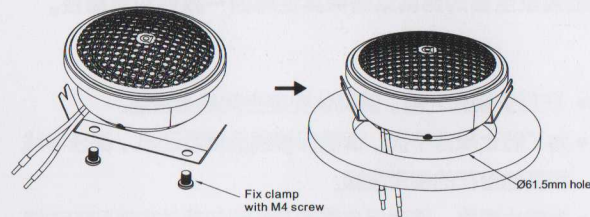

Installation 2:

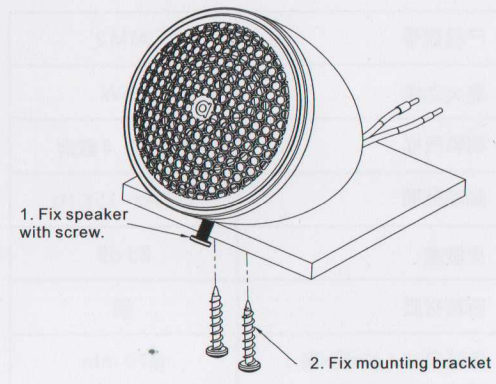

awave

ATM 2

ULTRA ATMOS SOUND SPEAKER
USER'S GUIDE